

This cover section is produced by the AIA Archives to show information from the online submission form. It is not part of the pdf submission upload.

## 2023 AIA Fellowship

Candidate Justin Crane  
Organization CambridgeSeven  
Location Cambridge, Massachusetts  
Chapter AIA Massachusetts;

### Category of Nomination

Object 3 > Led the Institute

### Summary Statement

Justin Crane has dedicated his career to promoting a just and ethical architectural profession by creating opportunities for education and fostering dialogue between the profession and the public.

### Education

Massachusetts Institute of Technology, Cambridge, MA / 3 years / M.Arch.

Harvard University, Cambridge, MA / 4 years / A.B. Visual and Environmental Studies

### Licensed in:

Massachusetts; California

### Employment

CambridgeSeven / Feb. 2006 - present / 16.5 years

Hubert Murray Architect & Planner / Feb. 2005 - Feb. 2006 / 1 year

Studio Daniel Libeskind / Internship June - Aug. 2002 / 3 months

HUBERT MURRAY FAIA | 204 ERIE STREET | CAMBRIDGE | MA 02139

t 617 794 4600 e hmurray2012@gmail.com

RK Stewart, FAIA  
Chair, 2023 Fellowship Jury  
The American Institute of Architects  
1735 New York Avenue, NW  
Washington, DC 20006-5292

October 4, 2022

Re: Candidate Justin Crane AIA for elevation to the College of Fellows: Object 3.

Dear Chairman Stewart and Jury members,

It is a great honor for me to recommend architect Justin Crane for elevation to the College of Fellows. I have known Justin personally since 2001 when I taught him in a graduate design studio at MIT. He later came to work in my office in 2004-5 helping to design an advanced low energy residential condominium in South Boston.

It was while he was working in my office that Justin founded Common Boston, the main purpose of which was to showcase to the general public new and notable buildings in the Boston area through organizing "open house" visits to buildings and presenting public lectures to lay audiences. The driving motive behind this program was to encourage interest and support for architecture through informed discussion. His later work with Learning By Design in Massachusetts (LBD:MA) extends this idea to young people through creative play and charrettes. Common Boston and LBD:MA have both been incorporated into the offerings of the BSA Foundation.

Complementary to his success in building public support and understanding of the profession, Justin has also devoted his energies to work as chair of the BSA Ethics Committee and for the last few years, on the AIA National Ethics Council of which he is currently the chair. In addition to hearing cases brought before the Council, he has worked to develop policy on issues of gender and ethnic discrimination and inequities in the workplace, and on professional involvement in ethically controversial projects such as the southern border wall, and facilities designed for execution and torture. Justin's reputation for fairness and integrity have made him a highly regarded leader in this difficult terrain.

Justin's practice is entirely consistent with the principles embodied in his work for public education and professional integrity. As a leader in his firm he has chosen to work on projects that support and develop communal benefits. His excellent capacity for listening and synthesizing diverse views has resulted in buildings that are well managed, well designed, and satisfying to the users. This approach to thoughtful practice is epitomized in his successful completion of The Foundry Building, an arts center located in a socially and economically diverse community.

Justin's dedication over the years to communicating to the public the value of architecture through practice and writing, to developing within the profession locally and nationally an adherence to high ethical standards, and his demonstrable integrity in his own practice, all reflect professional qualities that have already made a significant contribution to the profession that will only be enhanced by his elevation to the College of Fellows. I am proud to recommend Justin Crane for your consideration.

Yours sincerely,



Hubert Murray, FAIA (emeritus)  
Boston Society of Architects president 2007

*Justin Crane has dedicated his career to promoting a just and ethical architectural profession by creating opportunities for education and fostering dialogue between public and profession.*

### Connecting Public and Profession

Justin Crane led two grassroots initiatives that became cornerstones of the BSA Foundation's goal of furthering public interest in and engagement with architectural design. The first of these was Common Boston, which Justin launched and grew into a successful citywide festival of architecture and community — New England's largest public design event when it was adopted as a program of the Boston Society for Architecture (BSA).

As chair for five years, Justin oversaw the development of Common Boston from a grassroots organization into a key component at the core of the BSA's public outreach entity, the BSA Foundation. Under Justin's leadership, the multi-day, annual event, with over 200 free public programs, was locally-focused but national in scope, informed by countrywide expertise of visionaries like writer Anthony Flint and architect and urban designer Janet Marie Smith, Assoc. AIA. Further, the emerging professional volunteers have carried the legacy of Justin's program and work throughout the country empowering others through their work as architects, engineers, design professors, municipal executives, and candidates for office.

As Board President of Learning By Design in Massachusetts (LBD:MA), Justin led LBD:MA's reorganization that created a more financially sustainable programming approach, while also steering the organization's merger with the BSA Foundation. Under Justin's leadership LBD:MA led dozens of programs in Massachusetts grade schools, hosted monthly programs in the BSA Space, collaborated with the New York Learning By Design organization and served as a model for other Big Sib chapters adopting similar programming.

### Advancing Professional Ethics

Through his work fostering connections between the profession and the public, the importance of the AIA's Code of Ethics and Professional Conduct became a touchstone for Justin. From Chairing the BSA Ethics Committee to his current role leading the AIA National Ethics Council (NEC), Justin works to make the Code a relevant and tangible tool for peers around the country. His outreach and educational efforts regarding the code have been sought out by chapters beyond Boston and Justin has written extensively about how the code applies to a range of issues facing the evolving practice of architecture.

### Demonstrating Values Through Professional Practice

Justin has integrated community agency from early in design, building a more ethical practice with each project. As founder of CambridgeSeven's Diversity, Equity, and Inclusion Task Force, Justin champions a more equitable and inclusive practice through the pillars of Community Engagement, Educating Ourselves, Workplace Culture, Recruitment and Advancement, and Environmental Justice. His leadership has inspired emerging professionals to embrace volunteering and membership in civic organizations, investigate the ethical sourcing of specified materials, and adopt the AIA's Guides to Equitable Practice. Under Justin and the DEI committee's guidance, the firm focuses staff recruitment on schools with diverse student populations, and is building the talent pipeline through financial and staff volunteer support of the Digital Ready high school mentorship program.

Justin's built work bridges the gap between the profession and the public through community engagement and responsive design. He advocates for community voices in quality architecture - boosting neighborhood cohesiveness, advancing civic dialogue and creating welcoming buildings that create resources rather than consume them.

Justin Crane's commitment to a more ethical architectural profession and a more equitable built environment has guided his career, shaping his design practice and creating new opportunities for dialogue, education, and convocation in the Institute.

## Connecting Public and Profession

### Common Boston

**Leadership Role:** Co-Founder/Co-Chair 2005-2011

**Mission:** Bridge connections and increase understanding between designers and the public.

**Achievement:** Launched grassroots volunteer initiative to inspire and expand understanding of built environment and the public and grew it to an **11-day celebration that was a keystone program for BSA Foundation's** mission shift to a public programming organization.

**Highlights:**

- **Featured nationwide experts**, including Ed Mazria, Anthony Flint of the Lincoln Institute of Land Policy and Janet Marie Smith, now architect for the Los Angeles Dodgers
- **230 events**
- **5000 participants**
- Led more than **120 volunteers**, primarily emerging architectural professionals
- **Arranged national broadcast of perspectives of Boston youth through "YouthWalks Media Tours**, teen-produced, interactive videos about their own neighborhoods
- **Convened designers and citizens in Public Forums** on public space creation, public art, mixed-income housing advocacy, and Boston's new Innovation District
- **Created Common Build, a design-build competition to address** needs of community organizations in Boston's neighborhoods.
- Shared experiences and best practice through articles in national publications

See Exhibit 1

### Learning by Design:MA

**Leadership Role:** Board President, 2010-2015

**Mission:** Stabilize and grow vital non-profit community education initiative to broaden reach and achieve an economically sustainable future.

**Achievement:** Strengthened organization with roster of thought leaders in finance, non-profit management, education, and architecture, and **facilitated merger with local AIA chapter to expand reach of well-respected educational programming.**

**Highlights:**

- Engaged over **20,000 K-12 children, educators and architects/designers** in hands-on architecture and design programs both in and out of classrooms throughout Greater Boston
- Facilitated AIA New Hampshire's creation of a local LBD program
- Delivered curriculum resources and expertise to **AIA Chicago, AIA Virginia and AIA Vermont.**
- Founding partner of **ADEN (Architecture and Design Network)** of AAO (Association of Architecture Organizations), which supports educators and programs nationally.

See Exhibit 2

### ArchitectureBoston

**Leadership Role:** Editorial Board Member and Regular Contributor, 2015-2017

**Mission:** Diversify design conversation of quarterly architectural publication dedicated to creative thought leadership in critical social issues.

**Achievement:** **Increased chapter magazine's relevance by diversifying contributors** and focusing articles on community concerns of gentrification, historic preservation, density, and design process transparency.

**Highlights:**

- Shaped direction and focus of large-circulation (15,000) regional publication for **12 quarterly issues**
- **Advocated for new and diverse contributors and subject matter**
- **Promoted public-focused issues** drawn from grassroots experience linking architecture and the public
- **Author of six socially-focused articles and reviews**

See Exhibit 3

*"Justin Crane was part of a cadre of ArchitectureBoston board members whose 3-year terms were distinguished by the best kind of change. Throughout his time on the board, Justin quietly but deftly helped us open up the pages of AB to new, essential voices—helping the BSA personify the ideals of diversity, equity, and inclusion."*

*- Fiona Luis, Editor, ArchitectureBoston*

## Connecting Public and Profession

### BSA Foundation Public Programs Committee

**Leadership Role:** Member, 2015 - present

**Mission:** Expand public access to design education

**Achievement:** Forged partnerships and subsequent mergers of community-based programs as keystones of newly launched **BSA Foundation** to provide scalable, supportable community design education initiatives.

**Highlights:**

- Forged new committee partnerships to strengthen and expand programs that connect the profession with the public
- Advocated for new, student-focused programs, such as LEGO workshops **grade-school-based Student Design Days** and monthly **Family Design Days** workshops.
- Promoted **Boston Architecture Diary** online events calendar
- Implemented **AIA equity and sustainability goals**
- Expanded existing programs, including building tours, *What the Sketch?* fundraiser, and annual *KidsBuild!*

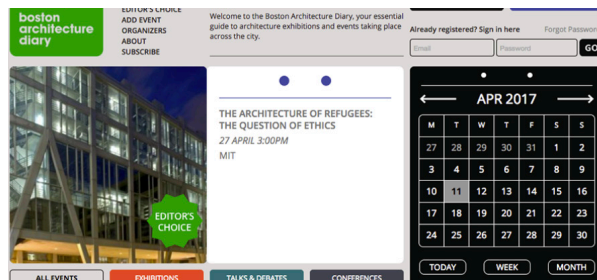

Boston Architecture Diary public events calendar

### Community-Focused Design Advocacy

- **AIA 2008 Convention Tour Planning Committee**—focused on stakeholder-led explorations beyond typical tourist fare - and leading a tour along and about the MBTA's subway, bus lines, and control centers
- **Local liaison for Next American City journal's URBANEXUS** event, resulting in a forum about municipal support for public art, 2009
- **Organizing Committee Member for the National Trust's Modern Modules** series of events on preserving mid-century architecture, 2010
- Presented on "**Innovation and the Public Process**," at Architecture Boston Expo, 2015
- Member of Master Plan **Engagement Working Group** for the City of Cambridge, 2016-2018
- Neighbors Project, **National Advisory Board**, 2007-2009



Learning By Design in Massachusetts Student Design Day

### Teaching

- Guest Lecturer - Boston Architectural College, "Professional Practice: Ethics & Leadership," Distance M. Arch. program, 2013-2014
- Guest Critic - Boston Architectural College, 2007-2010
- Research Assistant - Design for Development, Center for Real Estate, MIT, 2004
- Teaching Assistant - Experiencing Architecture Studio, MIT, 2003
- Teaching Assistant - Filming Science, Harvard University, 2000
- Guest Critic - Harvard University Graduate School of Design, MIT, BAC, Northeastern University, Wentworth Institute of Technology, 2005-2019
- Moderator for "Engaging Public Art and Placemaking," at Developing New Urbanism II: CNU New England Conference, 2007



Common Boston architectural tour of the Greenway

## Advancing Professional Ethics

### AIA National Ethics Council (NEC)

**Leadership Role:** Member, 2017-2022; Chair, 2022

**Mission:** Guide AIA members' conduct in fulfilling our ethical obligations to the profession, the public, clients, our colleagues, and the environment.

**Achievement:** Expanded NEC's position on environment and human rights and forged more robust communication with AIA membership.

#### Highlights:

- **Oversaw revisions** to "Rules of Procedure" to expedite process, limit exposure to the AIA and facilitate AIA member ethics education.
- **Launched Task Forces** to study the NEC's impact on:
  - AIA Strategic Council's Scalable Action Plan
  - Education Outreach to Membership on Ethical Issues
- **Hearing Officer** on four cases, settling disputes between AIA members, clients, and colleagues
- **Updated the Code of Ethics and Professional Conduct to address environmental stewardship and human rights:** covering discrimination, environmental equity and justice, standard of care, and places of execution and torture.
- **Reviewed ethics of design services** for US/ Mexico border wall and marijuana dispensaries
- **Issued advisory opinions** on recklessly misleading prospective clients and wanton disregard for the rights of others.
- **Presented to AIA North Dakota on "Our Ethical Obligations as Architects"** through interactive case studies
- Invited CEO of Grace Farms to introduce their **ethical material sourcing** initiative to the NEC

See Exhibit 4

### BSA Ethics Committee

**Leadership Role:** Member, 2010-2012; Chair, 2012

**Mission:** Expand membership understanding of National Ethics Council resources and tools

**Achievement:** In this elected position, increased educational programming and a thoughtful, rigorous approach to enforcing each of the Canons and obligations of professional practice.

#### Highlights:

- **Facilitated mediation** between parties who brought grievances to BSA Executive Director, resulting in resolution between parties before escalating to the NEC
- Developed **"Attribution of Credit Survey,"** 2012 distributed to firms nationwide in partnership with Brad Walker of the National Ethics Council and AIA Colorado
- **Guest speaker**, Boston Architectural College, Course TM7545: Leadership & Ethics, 2012
- Led **presentations on professional ethics** at the Architecture Boston Expo

See Exhibit 5

### Presentations

- "The Ethics of Building Material Supply Chains," presented at AIA North Dakota Convention, 2022
- "Our Ethical Obligations as Architects," presented at AIA North Dakota Convention, 2021
- "Ethical Considerations for New Jobs or Firms," at Architecture Boston Expo, 2016
- "Is Ethical Practice Good Practice?" Architecture Boston Expo Convention presentation, 2012

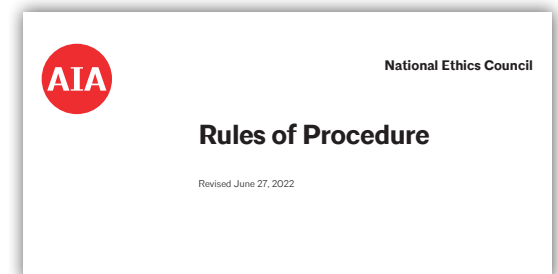

## Demonstrating Values Through Professional Practice

### Diversity, Equity, and Inclusion Task Force of CambridgeSeven

**Leadership Role:** Founding Partner (2020-present)

**Mission:** Bring national DEI conversation to CambridgeSeven to inspire meaningful change

**Achievement:** Catalyzed internal perspective shift at all levels through inclusive, participatory office-wide forum.

- **Coordinated staff K-2 classroom outreach** through the BSA Foundation's Our Boston program
- **Moderated office-wide Equity and Ethics forums** organized around AIA's Guides for Equitable Practice
- **Implemented firm-wide educational sessions and speaker series** focused on diversifying the profession
- **Broadened architecture school partnerships** to expand internship and work opportunities
- **Initiated JUST. certification process**
- **Wrote internal DEI work plan**
- **Coordinated firm participation in Digital Ready** mentorship program preparing Boston youth for careers in technology and design

### The Foundry Building

Cambridge, MA

**Role:** Project Manager

Net-zero ready, all-electric, and climate resilient preservation of historic structure and transformation with blend of revenue-generating office spaces to support community programs and fab labs, meeting rooms, art studios, and flexible performance.

**See Exhibit 6**

### Nettie M. Stevens Science & Innovation Center

Westfield State University

Westfield, MA

**Role:** Project Architect

First new academic building on public college campus ensures that students at an affordable state university have access to high-performance science facilities.

*Brick in Architecture Best in Class Winner, 2018*

**See Exhibit 7**

### New England Aquarium Master Plan and Renovation

Boston, MA

**Role:** Project Architect

Focused on environmental education and universal access, renovations include improved visitor eye-level viewing opportunities, accessible bridge to view top of Giant Ocean Tank, biophilic lighting, better demonstration and visitor engagement venues.

*BSA Accessibility Design Honor Award for Public Architecture, 2016*

**See Exhibit 8**

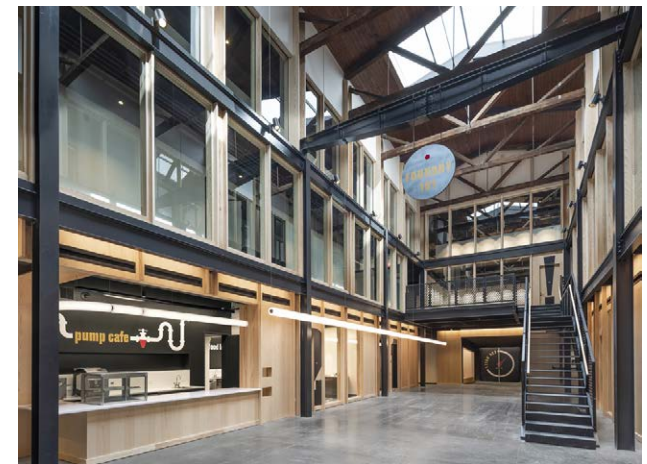

The Foundry - Community Hall



Williams Inn

## Demonstrating Values Through Professional Practice

### Williams Inn

Williamstown, MA

**Role:** Project Architect

New hotel redefines edge of town center with new town park, restored wetlands, and free and open terraces offering public space for dining and lounging on what was once a barren brownfield site.

*BSA Hospitality Award 2021*

### 26 Court Street Renovation

Boston, MA

**Role:** Project Director

Full interior renovation and facade restoration of a historic municipal office building with focus on public access through universally accessible exterior approach, reactivated historic main lobby entrance and gallery-style corridor leading to public transaction spaces.

### Civic Feasibility Studies

Justin has lead the completion of numerous feasibility studies for municipalities and non-profit organizations, including for:

- **Central Square Library Multi-family Housing Addition, 2022**  
Cambridge, MA  
Project Manager
- **Danehy Park Athletic Pavilion for scholastic sports programs, 2022**  
Cambridge, MA  
Project Manager
- **Inman Square Fire Station Renovation, 2021**  
Cambridge, MA  
Project Manager
- **105 Windsor Street Transformation of historic schoolhouse, 2021**  
Cambridge, MA  
Project Manager
- **Community Arts Center program in transformed historic firehouse, 2021**  
Somerville, MA  
Project Manager
- **Assembly Square Fire House, 2022**  
Somerville, MA  
Project Manager
- **Nantasket Center for the Arts, 2021**  
Hull, MA  
Principal in Charge

### Other Built Projects of Note

- **Ames Hotel Historic Renovation**  
Boston, MA
- **Roux Center for the Environment**  
Bowdoin College
- **Canada's Sports Hall of Fame**  
Calgary, Alberta
- **Marine Technology & Life Science Seawater Research Center**  
University of Miami
- **Wilson Hall Renovation**  
Westfield State University  
Westfield, MA
- **Hanover Inn and Conference Center**  
Hanover, NH
- **Hard Rock Café**  
Honolulu, HI



## Awards, Honors, and Recognition

### Individual

- **American Institute of Architects**  
2015 Young Architects Award
- **Building Design + Construction Magazine**  
2014 40 Under 40 Award
- **ULI Gerald D. Hines Urban Design Competition**  
2004 National Finalist
- **Massachusetts Institute of Technology**  
2003 Schlossman Fellowship for travel to eastern Canadian arctic to research design, construction, and provision of public housing
- **New England Film Festival**  
“Nowhere You Are” documentary film screened and distributed by Filmmakers Library, New York City, 2001



2015 AIA Honor Awards, Architect Magazine, May 2015. Portraits by Noah Kalina.

### Project

#### The Williams Inn

Williamstown, Massachusetts

- 2021 Hospitality Design Award  
Boston Society for Architecture
- 2020 Pinnacle Award of Excellence  
Natural Stone Institute
- 2020 Honorable Mention in Mountain Destination  
LIV Hospitality Design Awards

#### Nettie Stevens Science & Innovation Center Westfield State University

Westfield, Massachusetts

- 2018 Best in Class Winner  
Brick in Architecture Awards

#### Roux Center for the Environment Bowdoin College

Brunswick, Maine

- 2021 Architecture Award for Educational Buildings  
LOOP Design Awards
- 2020 Building of the Year Finalist  
ArchDaily

#### New England Aquarium Giant Ocean Tank

Boston, Massachusetts

- 2016 BSA Accessible Design Award  
Boston Society for Architecture

#### Marine Technology & Life Sciences Seawater Research Complex, University of Miami

Miami, Florida

- 2015 Best Project Award of Merit, Higher Education  
Engineering News-Record (ENR) Southeast

#### Canada's Sports Hall of Fame

Calgary, Alberta

- 2013 THEA Award for Outstanding Achievement  
Themed Entertainment Association

#### Hard Rock Café Honolulu

Honolulu, Hawaii

- 2012 Hawaii Green Business Award  
United States Green Business Council

#### Ames Hotel

Boston, Massachusetts

- 2010 Preservation Achievement Award  
Significant Rehabilitation / Restoration  
Boston Preservation Alliance
- 2009 Preservation Award  
Bostonian Society/Boston Historical Society

#### Hard Rock Café

Las Vegas, Boston, and Waikiki

- Hard Rock International  
2009 Project Development Partner of the Year

# Written About Justin and His Work

## Individual Features

- Quoted in **"Why we should build for wildlife as well as people"**  
BBC Future Planet, July 27, 2021. <https://www.bbc.com/future/article/20210727-how-to-boost-biodiversity-and-attract-wildlife-to-your-home>)
- "Tidal Shift - The Architect," by Michael McCarthy. *Boston Common*, April 2021
- "Common Boston Common Build" June 28, 2012, *Metropolis Magazine*
- "Discovering Common Ground through History and the Built Environment," by Megan MacIver. Project for Public Spaces Making Places Blog, July 20, 2010. <https://www.pps.org/common-boston/>
- "The Mermaid That May Connect the City," by Renee Loth. *The Boston Globe*, June 19, 2010
- "A Common Boston," by Tiffany Chu. Dwell, June 15, 2010 (<http://www.dwell.com/articles/a-common-boston.html>)
- "An Architect/Activist Works to Repair the Public's Trust" published in the *Boston Business Journal*, August 21, 2009
- "Not my dad's Peabody Square," By Thomas Gagen, Editor. *The Boston Globe*. May 13, 2008

## Project Features

- "Cambridge Cuts Ribbon on Transformed Foundry 101 Building, a New Space for Artists" *Cambridge Chronicle Tab*, June 29, 2022
- "CambridgeSeven Honored with 2021 Hospitality Design Award by Boston Society for Architecture" *Boston Real Estate Times*, February 22, 2022
- "Williams Inn by CambridgeSeven" *Traditional Building Magazine*, November 8, 2021
- "LEED-Platinum Learning Lab is a Beacon of Sustainability" *Inhabitat*, February 10, 2020
- "Roux Center for the Environment / CambridgeSeven" *ArchDaily*, January 28, 2020
- "'We're on the Right Track:' Cambridge Unveils Updated Plans, Timeline for Foundry Building" *Cambridge Chronicle*, October 4, 2019

- "Check-in Time Arrives for New Williams Inn" *The Berkshire Eagle*, August 15, 2019
- "New Hotels for Getaways by the Ocean, in the Country, and in Beacon Hill" *Boston Magazine*, August 8, 2019
- "Hospitality Designs Influence Office and Academic Projects" *Banker & Tradesman*, July 28, 2019
- "Green Movement Grows Brighter on Campuses in Maine" *The Times Record*, November 1, 2018
- "Visiting Colleges? The Era of Staying in a Sad Hotel is Over" *Bloomberg*, September 18, 2018
- "Making Waves: University of Miami is Now Home to World's Largest Hurricane Simulator" *The Architects Newspaper*, February 18, 2018
- "Kraft, CBS Focus on a Concept Restaurant: TV, Sports Will be Dual Themes on Menu" *The Boston Globe*, December 9, 2007

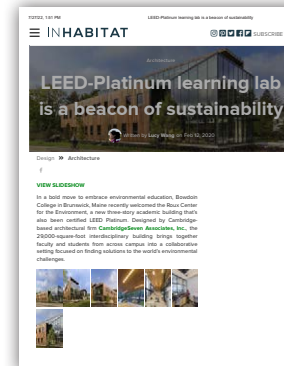
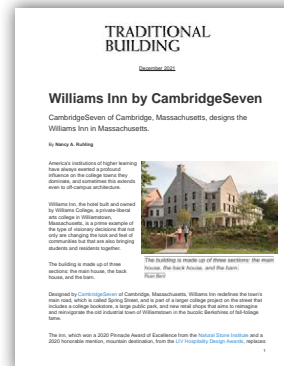
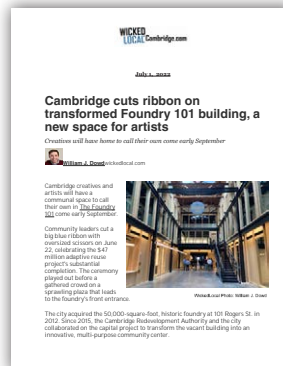

Written by Justin

- "Design Ethics with Justin Crane, AIA" CambridgeSeven.com, June 13, 2022
- "Ten Ways to Design Architecture for Wildlife" CambridgeSeven.com, September 29, 2020
- "Blue Architecture: Building for Our Oceans" CambridgeSeven.com, May 5, 2020
- "Restoration of Cambridge's Foundry Preserves Important Stories, Unlocks New Features" *Banker & Tradesman*, February 10, 2020
- "Preservation: Is Gentrification Inevitable?" Fall 2015: Preserve *ArchitectureBoston* Volume 18 n3

- "Failure is an option: The value of admitting error" September 2018 *Architecture Boston*
- "Toward an Ideal" March 2017 *ArchitectureBoston*
- "Creating Common Ground: Sharing Our Work With the Public" February 2016 *Connection*
- Review of "Made for Walking" by Julie Campoli March 2014 *ArchitectureBoston*

- Review of "The Boston Modern Module: National Trust for Historic Preservation." Nov/Dec 2010: unmodern *ArchitectureBoston* Volume 13 n4
- "Winterscapes: Shaping our views of Northern cities." Nov/December 2006: Winter *ArchitectureBoston* Volume 9 n6
- "A Public Space for a Winter City" (MArch graduate thesis) 2005 saved in Winter Cities Institute archives





### Connecting Public and Profession

---

1. **Common Boston**  
2005-2011
2. **Learning by Design in Massachusetts**  
2010-2020
3. **Architecture Boston**  
2015-2017



### Advancing Professional Ethics

---

4. **National Ethics Council**  
2016-2022
5. **BSA Ethics Committee**  
2010-2012



### Demonstrating Values Through Professional Practice

---

6. **The Foundry Building**  
2022
7. **Nettie M. Stevens Science and Innovation Center, Westfield State University**  
2016
8. **New England Aquarium Master Plan and Giant Ocean Tank**  
2011, 2014

## 1. Common Boston

**Leadership Roles: Co-Founder, 2005;  
Co-Chair, 2005-2011**

**Challenge:** Connect community with architects to link the importance of quality design to a sustainable, equitable, and inspiring built environment and elevate response to stakeholder needs.

**Results:**

- Grew program from a small, grassroots organization to an **11-day, city-wide celebration**
- Directed more than **500 events over 11 years:**
  - **D-Party**, bringing together designers and community organizations
  - **Building Tours** led by architects, owners, contractors, artists, engineers, city officials, and residents
  - **Forums** on topics from City Hall Plaza and public art to affordable housing and the importance of shared open spaces
  - National **photography competitions**
  - Common Boston Common Build, a 48-hour **design-build competition**
  - **YouthWalks Media Tours:** created by teens
  - **Film Screenings**
  - **Design Competitions**
- Coordinated more than **120 volunteers**, including emerging architects and designers who are now:
  - Campus planners; political office-holders; real estate lawyers; municipal transportation planners; and practitioners and teachers across the country
- Received a National Endowment for the Arts grant for Common Boston programming

*“Common Boston challenges two stereotypes about this city: that it is too square to host such a creative party; and that it is too balkanized to cross various social lines.... the festival manages to address this without lecturing. Instead, the connections arise organically.” – “The Mermaid That May Connect the City” by Renee Loth. Boston Globe, June 19, 2010.*

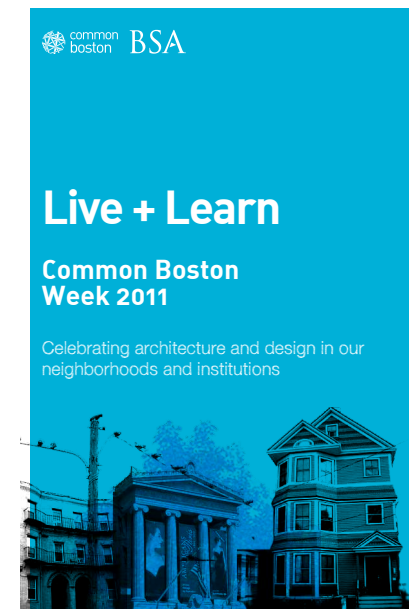
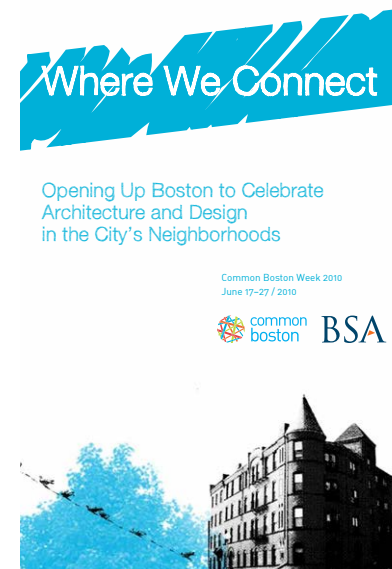

Common Boston programs covers 2007-2011

# 1. Common Boston

- Featured in journals both locally and nationally:
  - **“Common Boston Common Build”** *Metropolis Magazine*, June 28, 2012.
  - **“Creating Common Ground: Sharing Our Work With the Public”** *Connection*, February 2016.
  - **“Not my dad’s Peabody Square”** by Thomas Gagen, Editor. *The Boston Globe*, May 13, 2008.
  - **“A Common Boston”** by Tiffany Chu. *Dwell*, June 15, 2010.
  - **“The Mermaid That May Connect the City”** by Renee Loth. *The Boston Globe*, June 19, 2010.

**Declaration of Responsibility:**

I have personal knowledge of the nominee’s responsibility for the project shown above. That responsibility included: Project under the direction of the nominee as Founder and Co-Chair.

Eric White, Hon. AIA, Executive Director, Boston Society for Architecture

**Fort Point**

**Historic Fort Point: An Infrastructure Walking Tour**  
 Sunday / June 20 / 1:00-2:30 PM  
 Broadway / Station

**Boat Tour: Development on the Waterfront**  
 Sunday / June 20 / 3:00-5:00 PM  
 Monday Federal Courthouse, 1 Court House Way

**FPAC Artist Housing Tour**  
 Sunday / June 20 / 3:00-4:30 PM  
 496C Street, 12 Forest Hills St

**Photo Discussion of Fort Point**  
 Saturday / June 19 / 1:30 PM  
 Pier 20, Summer St

**Family Interactive Tour**  
 Sunday / June 20 / 11:00 AM-12:00 PM  
 Boston Children's Museum, 300 Congress St

**SHIFBoston Ideas**  
 Ongoing  
[www.shifboston.org](http://www.shifboston.org)

Registration required. Visit [www.commonboston.org](http://www.commonboston.org) for instructions.

Common Boston Week 2010  
[www.commonboston.org](http://www.commonboston.org)

**chinatown /**

**Berkeley Street Community Gardens Audio Tour**  
 Berkeley Street Community Gardens  
 A self-guided tour.  
 Most people think Chinatown is all tall buildings and narrow streets – but gardens have long been central to life in Chinatown. This garden tour, narrated by Sarah Hult, explores the role of the gardens in the community and the larger city.  
 Production provided by Auditory Guides.

**The Participatory Chinatown Project**  
 38 Oak Street  
 Engaging the Community in Growth.  
 This innovative approach to mediating the effect of development within the neighborhood seeks to give residents the tools to capitalize on growth as it happens.

**Project Place / 2**  
 Project Place, 145 Washington Street  
 Project Place is a supporter community that promotes opportunity for homeless and low-income individuals by providing the skills, education and resources needed to obtain stable employment and housing. Join us for a tour of their new sustainable building, Gatehouse, with David Taberken of Hacin + Associates, and for a discussion of Housing First policy with Gerrie Kulkarni of Housing Home.  
 Pre-registration is recommended.

**Food Tour with Nadine Nelson**  
 New Chinatown Gate  
 Local culinary expert Nadine Nelson shares her insights into Chinatown’s rich food culture, complete with dum dum.  
 Pre-registration is recommended due to limited space.

**Parcel 24 and the Future of Housing in Chinatown**  
 38 Oak Street  
 Housing in Chinatown is a problem, as the community has improved its safety and appeal, the city has gentrified, pushing land values beyond what residents can afford. The ACDC has led the effort to give the community access to new construction. Hear a variety of solutions from ACDC Real Estate Project Manager Janella Chan, and follow the self-guided tour to each location.

**Project Place / 1**  
 Project Place, 145 Washington Street  
 Project Place is a supporter community that promotes opportunity for homeless and low-income individuals by providing the skills, education and resources needed to obtain stable employment and housing. Join us for a tour of their new sustainable building, Gatehouse, with David Taberken of Hacin + Associates, and for a discussion of Housing First policy with Gerrie Kulkarni of Housing Home.  
 Pre-registration is recommended.

**Chinatown’s New Gate**  
 New Chinatown Gate  
 Learn about the process of designing Chinatown’s presence on Boston’s premiere green space, the Row Kennedy Greenway, in the form of the New Chinatown Gate. Architects from Carol R. Johnson Associates, the site’s designers, will lead a tour.  
 Be sure to check out the events of the Chinatown Main Streets Festival taking place on Sunday.

## 1. Common Boston

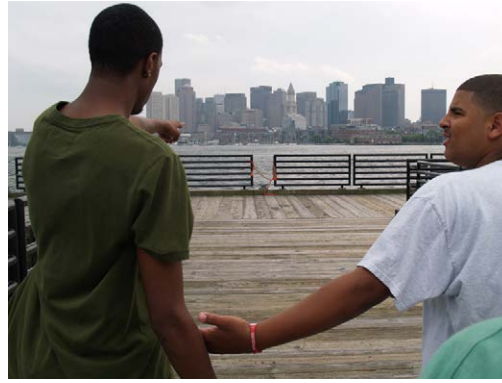

### We Are Here

Multimedia walking tours of Boston neighborhoods created by youth from The Teen Initiative.

Visit [www.commonboston.org](http://www.commonboston.org) to download to your phone or iPod.

Brought to you by Common Boston Week 2010—a celebration of design, architecture and communities.



YouthWalks Media Project & Walking Tour



Common Boston Common Build competition designs from teams representing Boston Architectural College, Cooper Union, and Syracuse University

## 1. Common Boston

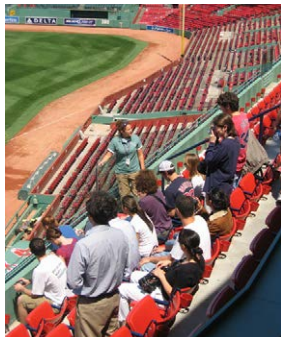

Common Boston tours

FEATURE MEDIUM

## CREATING COMMON GROUND: SHARING OUR WORK WITH THE PUBLIC

by Justin Crane, AIA

People often tell us that they would have loved to have been an architect. Yet despite this enthusiasm for our job, there is a noticeable lack of enthusiasm for progressive design as well as a lack of trust in the building process. As a result, we're perceived as elitist professionals with little relevance to many people's lives. This is unfortunate, since our skills are increasingly important as building performance and design are more closely linked to public health and environmental sustainability. More fundamentally, architecture is our only chance to imagine and build the world in which we want to live.

We need an even more effective way to communicate with the American public. For all the power of new media and sound bites, I don't believe these are the best means of raising the public's appreciation of design. We must use the medium in which we work, and invite more citizens to visit architecture.

Just as music reviews would not be interesting to those with no chance to hear the pieces, discussions about architecture will be irrelevant to those without the chance to experience a variety of buildings. Photographs and sentences do not do justice to the total sensory experience of architecture; they cannot recreate the social aspect of inhabiting a great civic building. We build by shaping space, and we must create more opportunities for the American public to experience this medium if we are to begin fruitful conversations on the importance of architecture.

With this in mind, a group of emerging architects and I co-founded Common Boston to create a variety of opportunities for dialogue between architects, clients, contractors, and residents. In the five years I was co-chair of Common Boston we organized 230 events in 24 Boston neighborhoods, with events such as open buildings, hard-hat tours, neighborhood walks, bicycle rides, picnics, foraging expeditions, group art projects, photo scavenger hunts, and mobile phone tours. All events eliminated boundaries that were social – allowing for dialogue between architects and residents in informal settings away from the high-pressure arena of community meetings – as well as physical – allowing the general public into spaces that were closed or required an entrance fee at other times of year.

Eliminating presumed boundaries is also core to the work of Learning By Design in Massachusetts (LBD:MA), on which I have served as board president since 2012. Since its founding in 1999, the organization has brought architectural studio projects and neighborhood study tours to more than 20,000 grade school students. The majority of these students go to inner-city schools and represent a demographic that remains dramatically underrepresented in our profession (and in our client base). By encouraging students to explore their neighborhoods and then following up with in-person conversations between the students, teachers, and visiting professionals, LBD:MA is building a new generation committed to improving our communities through architecture.

In the last year, Common Boston and LBD:MA programming have become part of the Boston Society of Architect's new civic engagement organization, the BSA Foundation. Steered by the BSA's executive director, Eric White, as well as several BSA presidents and BSA Foundation board chairs, the BSA Foundation is a new chapter for the architecture profession in the Boston area. The foundation will reinforce the importance of places in our communities – not by PR campaigns or increased use of new media – but by creating more opportunities for architects and the general public to meet and to create together in these spaces. These opportunities range from gallery openings and KidsBuild! in the new BSA Space gallery, to sketch walks and "Dining with Design" nights throughout the city.

Just as music reviews would not be interesting to those with no chance to hear the pieces, discussions about architecture will be irrelevant to those without the chance to experience a variety of buildings.

Several other large cities have active architecture centers; yet we should try hard to curate similar events in communities of all sizes, as these are our best chance to improve the public's perception of architects and architecture – as well as to educate ourselves about the needs of the general public. While residential open houses are already a popular pastime, we should focus more on civic buildings and opportunities for bringing together citizens for dialogue – no doubt such opportunities will be even more beloved by the public. Formats for doing so could include a nationwide "open doors" weekend, popular ballots on a community's best new building or interior space (featuring ballot boxes in those spaces), or public events celebrating building openings. Finally, we should meet citizens in the places that are meaningful to them by focusing our efforts on civic outreach – via the 1+ Program, design-build efforts in underserved neighborhoods, or travelling exhibitions.

We should explain ourselves in our own medium – through opportunities to bring more people into the buildings and spaces of which we're most proud. Open buildings and neighborhood-based events are, by necessity, local. They don't reach a national audience as instantaneously as a YouTube video. However, their effects will be more memorable and longer-lasting, creating a citizenry more devoted to the quality of our built environment. ■



## 2. Learning By Design in Massachusetts

**Leadership Role:** Board President, 2010-2015

**Challenge:** Shepherd organization through difficult transition to a 501(c)3; restructure organization leadership; and introduce more streamlined programming to expand participation.

**Results:**

- **Recruited seven new board members** with expertise in finance, education, and non-profit management to advance LBD:MA's mission.
- Served over **25,000 children, educators and architects/designers** and an average of **40 volunteer architects** per year.
- **Family Design Days** at BSA Space: Two-hour hands-on workshops introducing families to architecture and design.
- **11 Annual KidsBuild! Weekends**, during which kids designed, permitted and built models to populate a large-scale city floor map
- Ran **grade school classroom programs** in ten Boston neighborhoods
- Organized BSA "What the Sketch" **fundraisers**
- **Led merger** of LBD:MA with the Boston Society for Architecture, forming cornerstone of BSA Foundation.
- **Inspired similar LBD programming** for other AIA components
- Provided resources and support to **AIA New Hampshire, AIA Chicago, AIA Virginia and AIA Vermont**
- **Founding partner of the Architecture and Design Network (ADEN) group**, supporting educators and programs nationally, including by hosting the Association of Architectural Organizations (AAO) national conference in 2013.



LBD:MA Student Design Days at Greater Boston schools

## 2. Learning By Design in Massachusetts

*Declaration of Responsibility:*

*I have personal knowledge of the nominee's responsibility for the project listed above. That responsibility included: Project under the direction of the nominee as President of the Board of Directors*

*Polly Carpenter, FAIA, Program Director, Learning By Design in Massachusetts | Director of Public Programs, Boston Society of Architects*

Since Justin oversaw the merger of LBD:MA and the BSA, and during his tenure on the Public Programs Committee, youth programs at the BSA have worked with:

**15,550** Students

**700** Volunteers

In 2021, **78%** of students attended schools where at least **80%** of students identify as BIPOC



KidsBuild 2013



Family Design Day

## 2. Learning By Design in Massachusetts



### About



A K-12 architecture and design education program dedicated to igniting the *creative spark* in every child.

Dear LBD:MA Community,

I'm writing to announce that Learning By Design in Massachusetts (LBD:MA) has entered an exciting new partnership with the BSA Foundation (the Foundation).

BSA online announcement of merger with LBD:MA



"I'm always amazed at what kids can accomplish with cardboard boxes, colored paper, imagination, and a little time with architects."  
~ D. Paul Moore, Architect

### Learn More

- About
- News + Articles
- Special Projects
- For Parents
- Funding Toolkit
- Resources
- Contact Us

### My Tweets



### Building Types

<b>Residential:</b> <p>Where we live. Single Family Houses Two Family Houses Triple Deckers Apartment Buildings Condominiums</p>	<b>Commercial:</b> <p>Where we buy things. Where we sell things. Grocery Stores Clothing Stores Offices Banks Law Offices Movie Theaters Restaurants Toy Stores Barber Shops Hotels Gas Stations Arcades Art Galleries</p>
<b>Civic &amp; Public:</b> <p>Where we gather. Where we learn. Where we take care of one another. City Halls Town Halls Courthouses Fire Stations Police Stations Hospitals Senior Centers Nursing/Assisted Living Homes Churches, Synagogues, Mosques Community Centers Schools Libraries Museums Sports Facilities Zoo's</p>	<b>Industrial &amp; Agricultural:</b> <p>Where we make things. Where we grow things. Factories / Mill Farms Power Plants Waterworks Warehouses</p>
<b>Services:</b> <p>Where we go to get from place to place. Train Stations Airports Bus Stations Roads Sidewalks Parking Lots</p>	<b>Recreational:</b> <p>Where we play. Where we enjoy nature. Parks Playgrounds Amusement Parks Bike Paths Preservation Lands</p>

### Elements of Sustainable Design

**SYSTEMS-THINKING:**  
What is the essential relationship between people, nature and our buildings?  
How will you use these elements of sustainable design?

**SITE:**  
Climate - Is your design appropriate for the climate?  
Natural Habitat - How will you protect what is already on the site?  
Density - How many people will be using the resources of the site?  
Transportation - How will you travel to your site?  
Community Identity - How will your design contribute to the history & culture of your community?

**SUN:**  
Path of the Sun - Do you understand how the sun affects your design?  
Passive Solar Design - Solar Heat Gain - How can you use the heat of the sun to your advantage?  
Natural Daylighting - How can you take advantage of the sun's light?  
Solar Energy Production - How can your design use the sun's energy to create electricity?  
Solar Thermal Production - How can your design use the sun's energy to heat water?

**WIND:**  
Air Currents - Do you understand how the wind affects your design?  
Natural Ventilation - How can you take advantage of the wind to circulate fresh air?  
Natural Cooling - How can you take advantage of the wind to cool your spaces?  
Wind Energy Production - How can your design use the wind's energy to create electricity?

**WATER:**  
Water Cycle - Do you understand how the ground water, surface water & rain affect your design?  
Watershed Conservation - How can you protect water resources?  
Interior & Exterior Water - How can your design minimize water use?  
Water-Energy Production - How can a building take advantage of the water's energy and treat its waste electricity?

**MATERIALS:**  
Renewable/Non-Renewable & Life-Cycle Costs - How much do your materials cost to make, use and recycle?  
Building Envelope - How well is your building made?  
Transportation Costs - How did your materials travel to get to your site?  
Interior Air Quality - How do your building materials contribute to a healthy interior?  
Waste - How will you dispose of the extra materials? What's left over?

Curriculum posters developed by LBD:MA

### City Organizations

**Grid**

**Linear**

**Centralized / Radial**

**Clustered / Random**

## LBD:MA

### Learning By Design in Massachusetts

A K-12 architecture and design education program

In LBD:MA programs, children use 21st century skills to engage in hands-on, real-world design projects based on the places and spaces in their lives.

**LBD:MA provides:**

- Workshops for K-12 students and teachers
- Volunteer opportunities for architects
- Curricular partnerships with organizations

**LBD:MA Children's Workshop Themes:**

- Community
- Digital Design
- Learning Spaces
- Living Spaces
- Math
- Stories
- Sustainability

**LBD:MA's goals are:**

- to give young people the opportunity and skills they need to communicate their ideas about their built and natural environments, about their community and about themselves;
- to engage children in architecture and design projects with professional architects and designers;
- to give educators the training and support they need to engage K-12 students in architecture and design projects that are interdisciplinary in nature and closely aligned with the state learning standards;
- to enable the next generation to build a better future.

Visit us at BSA (SPACE)  
290 Congress St, Suite 200,  
Boston MA 02210  
and on the web:  
[www.lbdma.org](http://www.lbdma.org)

"LBD:MA brings the profession of architecture into the classroom, connects students to their environment in a tangible way, and motivates them to think about how buildings help to create their community... Every year the incoming 3rd graders ask, 'When will the architects come?'"  
- a Boston Teacher

### 3. Architecture Boston

**Leadership Roles:** Editorial Board, 2015 – 2017; and Regular Contributor

**Challenge:** Create content of interest to design professionals and the public to increase readership and challenge assumptions about practice.

**Results:**

- **Wrote six articles with varied subject matter:**
  - "Winterscapes: Shaping our views of Northern cities." Nov/Dec 2006: Winter
  - Review of "The Boston Modern Module: National Trust for Historic Preservation." Nov/Dec 2010: unmodern
  - "Preservation: Is Gentrification Inevitable?" Fall 2015: Preserve
  - "Failure is an option: The value of admitting error" Sep 2018
  - "Toward an Ideal" March 2017
  - Review of "Made for Walking" by Julie Campoli. March 2014
- Provided editorial board review and thought leadership for **12 quarterly issues with a circulation of 15,000**

**Declaration of Responsibility:**

I have personal knowledge of the nominee's responsibility for the project listed above. That responsibility included: *Project under the direction of the nominee as author and as Editorial Board member.*

*Renée Loth*

Renée Loth, Editor, ArchitectureBoston

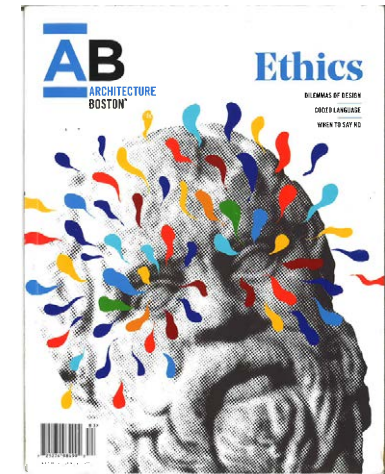
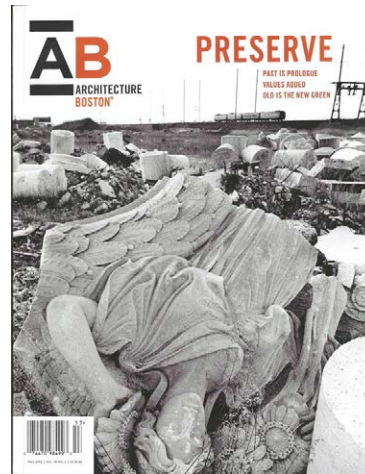

Architecture Boston Covers: Fall 2015; Spring 2017; Fall 2018

## 4. National Ethics Council

**Leadership Roles:** Chair, 2022; Member from 2017 - 2022

**Challenge:** Advise AIA Board on professional ethics, transforming the Council to not only react to complaints but also become a proactive and leading voice in the AIA.

**Results:**

- Served as **Hearing Officer** for five cases.
- **Ruled**, with other Council members, on **19 cases**
- Crafted **four Code of Ethics updates**:
  - Strengthening language regarding harassment and discrimination and our obligation to provide an **equitable work environment**
  - Making mandatory our responsibility to the **natural environment**
  - Barring members from designing places of **torture and execution**
  - Clarifying language to reduce confusion and **streamline case review**
- **Issued two advisory opinions** relating to recklessly misleading prospective clients and wanton disregard for the rights of others
- **Reviewed ethical implications** of engaging in professional services for US/Mexico border wall
- Presented “Our Ethical Obligations as Architects” at AIA North Dakota 2021 Convention, including an **interactive session** on three case studies
- As chair, **initiated development of Educational Outreach program** for NEC through formation of task force, analysis of most common conflicts over last 10 years, and continuing education

**Declaration of Responsibility:**

*I have personal knowledge of the nominee's responsibility for the project listed above. That responsibility included: Project under the direction of the nominee as Ethics Council member and Chair*

---

*Terrence Ona, Senior Vice President & General Counsel,  
American Institute of Architects*

- As chair, **created task force** focusing on how professional ethics can support the goals of the AIA's Scalable Action Plan on Climate Change
- As chair, **updated Rules of Procedure** to facilitate process, reduce time for hearing of Complaints, and allow more time for NEC members to focus on Educational Outreach
- Organized meeting between **Design for Freedom** initiative and National Ethics Council with focus on the ethical sourcing of materials

Our Ethical Obligations  
as Architects

2021 Design Conference &  
Building Products Exposition  
October 6, 2021

**Justin Crane, AIA NCARB**  
AIA National Ethics Council



**AIA**  
North Dakota

---

*6 years on the National Ethics Council*

*5 cases as Hearing Officer*

*11 cases reviewed as Chair*

*19 cases decided on National Ethics Council*

---

# 4. National Ethics Council

## 2022 Revisions

This is the first revision of the Rules of Procedure in six years, and one of the most comprehensive since their institution. The revisions add efficiency to the hearing of cases, minimize legal exposure for the NEC, and address a recent trend of weaponizing the Code of Ethics.

## Streamline Process

By making the process for hearing cases more efficient, the revised Rules of Procedure allow for the NEC to take a more proactive stance towards educating Members. This sentence offers an explicit reminder of this goal.

## Simplify Future Changes

Previous versions of the Rules of Procedure were not explicit about the means by which they could be changed or waived, partly because these changes have been so infrequent. Sections 1.1 and 1.2 fill this void.

## Clarify Non-investigatory Role

Section 1.3 makes explicit that the NEC is not an investigatory body, making clear the NEC's role to Complainants and Respondents.

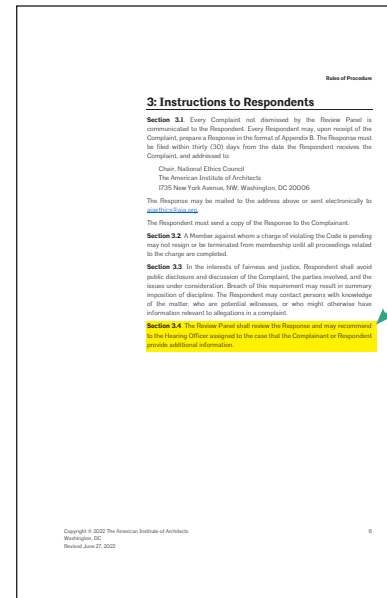
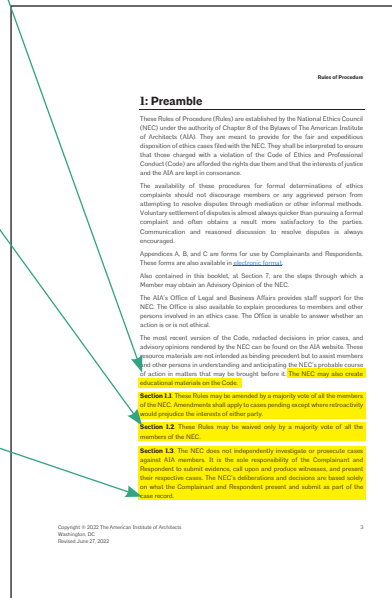
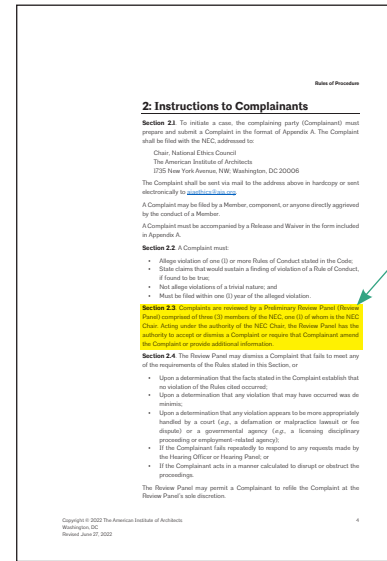
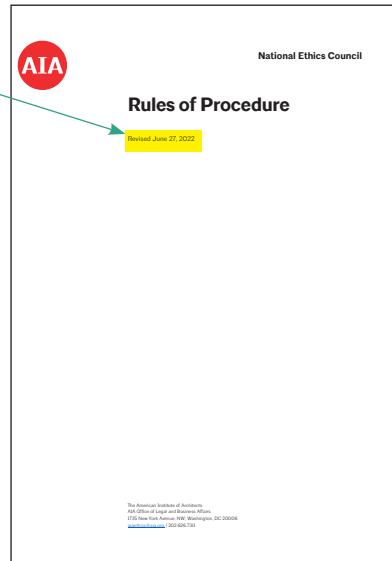

## Minimize Exposure

Until 2022, the Hearing Officer had sole authority to initially review Complaints and to accept or dismiss them. Section 2.3 institutes a Review panel of three NEC members, limiting exposure and the chance of implicit bias, while also allowing for NEC members to see more cases during their tenure.

## Establish Review Panel Authority

The newly-instituted Review Panel's authority extends to providing recommendations to the Hearing Officer assigned to the case that the Complainant or Respondent would not otherwise receive.

## 4. National Ethics Council

### Modernize Process

As a result of revised expectations regarding communication and travel due to the Covid-19 pandemic, as well as to expedite case hearings, the Hearing Officer is given discretion as to whether hearings will take place virtually or in person.

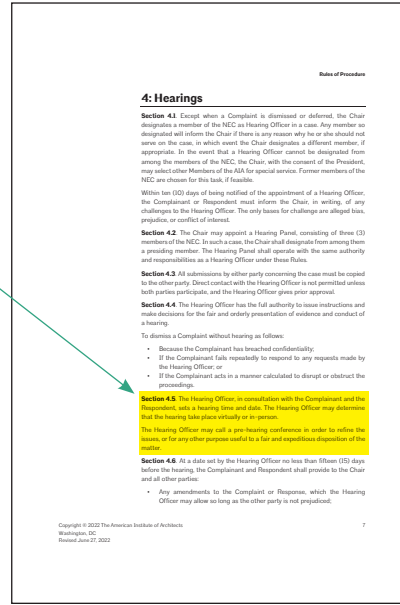

### Streamline Process

This section reduces the required components of the Hearing Officer's Report and Recommendation to expedite the issuance of recommendations as well as to limit legal exposure of the AIA. Further, the list of penalties has been moved to the AIA's By-Laws and revised based on an understanding of how printed censures may work given the longevity of information on the internet - something that was not a consideration when the original rules of procedure were written.

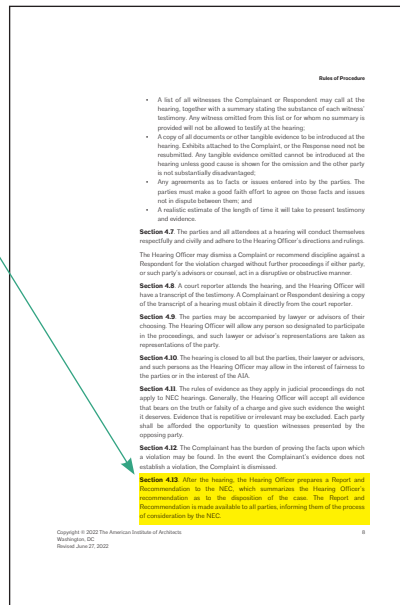

### Educate the Profession

In an additional effort to encourage education of Membership, Chapter 7 has expanded the types of decisions that may be published in a redacted form.

### Minimize Exposure

One impact of this addition to the Rules of Procedure is the ability of the Board to review the ethical track record of candidates for AIA awards.

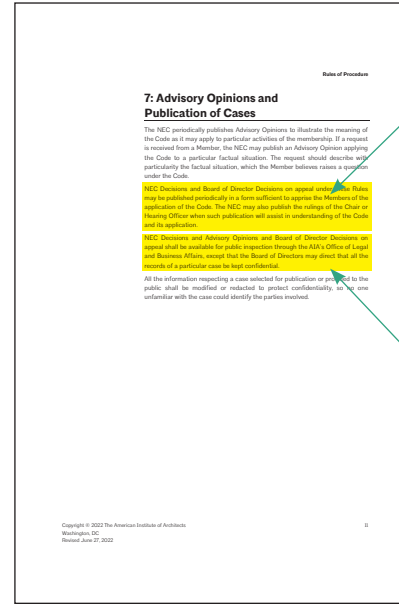

# 4. National Ethics Council

## Minimize Exposure

The 2020 edition of the Code added this Statement, limiting liability to professionals and to the AIA.

**2020 Code of Ethics and Professional Conduct**  
FROM THE OFFICE OF GENERAL COUNSEL

**Canon 1: Minimize Exposure**  
Members of the American Institute of Architects are defined to the highest standards of professional integrity, and conduct of the American Institute of Architects and its members shall be held to the highest standards of professional conduct. The Code is intended to guide the conduct of Members in fulfilling these obligations. The Code is arranged in three areas of relevance: Canon, Ethical Standards, and Rules of Conduct.

**Canon 1: Minimize Exposure**  
Members should appear in professional performance and behavior.

**Canon 2: Oppose Torture and Execution**  
Members should oppose the practice of torture and execution in any form, including but not limited to the use of capital punishment, and should support the abolition of the death penalty.

**Canon 3: Protect Natural Environment**  
Members should protect the natural environment and the health and well-being of the planet.

**Canon 4: Improve Workplace Culture**  
Members should create a workplace environment that is safe, healthy, and equitable.

**Canon 5: Support Human Rights**  
Members should support the rights and dignity of all people.

## Improve Workplace Culture

The 2018 edition of the Code added an explicit reference to and definition of "harassment" and added "gender" and "gender identity" as protected classes to bring the Code up to date with the values of the profession.

## Support Human Rights

Rule 1.404 was added together with Rule 1.403, bringing the Code in alignment with international standards for human rights regarding solitary confinement, citing definitions from the United Nations Nelson Mandela Rules.

## Oppose Torture & Execution

Rule 1.403 and its Commentary were added to the 2020 Code to align the code with the AIA's value of upholding human rights

## Protect Natural Environment

While the 2007 Edition of the Code of Ethics added Canon VI "Obligations to the Environment," there were no Rules regarding our responsibility to the environment. The 2018 version of the Code added Ethical Standard 2.4 and Rule 2.401 as part of our Obligations

**2020 CODE OF ETHICS AND PROFESSIONAL CONDUCT**

**Canon II: Obligations to the Public**  
Members should recognize the right and duty of the public to be informed and to participate in the decisions that affect their lives. Members should support the public interest in the decisions that affect their lives.

**Canon III: Competence**  
Members should maintain the highest level of competence in their professional practice.

**Canon IV: Integrity**  
Members should not engage in conduct that is dishonest or deceptive.

**Canon V: Confidentiality**  
Members should not disclose confidential information.

**Canon VI: Fairness**  
Members should not engage in unfair or deceptive practices.

**Canon VII: Honesty**  
Members should not engage in false or misleading statements.

**Canon VIII: Diversity and Inclusion**  
Members should support the rights and dignity of all people.

**Canon IX: Support Human Rights**  
Members should support the rights and dignity of all people.

**Canon X: Improve Workplace Culture**  
Members should create a workplace environment that is safe, healthy, and equitable.

**2020 CODE OF ETHICS AND PROFESSIONAL CONDUCT**

**Canon XI: Support Human Rights**  
Members should support the rights and dignity of all people.

**Canon XII: Improve Workplace Culture**  
Members should create a workplace environment that is safe, healthy, and equitable.

**Canon XIII: Oppose Torture and Execution**  
Members should oppose the practice of torture and execution in any form, including but not limited to the use of capital punishment, and should support the abolition of the death penalty.

**Canon XIV: Protect Natural Environment**  
Members should protect the natural environment and the health and well-being of the planet.

**Canon XV: Minimize Exposure**  
Members should appear in professional performance and behavior.

**Canon XVI: Support Human Rights**  
Members should support the rights and dignity of all people.

**Canon XVII: Improve Workplace Culture**  
Members should create a workplace environment that is safe, healthy, and equitable.

**Canon XVIII: Oppose Torture and Execution**  
Members should oppose the practice of torture and execution in any form, including but not limited to the use of capital punishment, and should support the abolition of the death penalty.

**Canon XIX: Protect Natural Environment**  
Members should protect the natural environment and the health and well-being of the planet.

**Canon XX: Minimize Exposure**  
Members should appear in professional performance and behavior.

## Improve Workplace Culture

As a complement to the expansion of the Code to include discrimination, Rule 5.101 was added to make clear that Member's treatment of their colleagues and employees must be respectful and equitable.

## Minimize Exposure

Commentaries to Rules 4.101 and 4.202 were added to clarify the circumstances under which the Rule may be applied, limiting confusion amongst Members.

## Protect Natural Environment

Rule 6.501 provided a critical tool to enforce our obligations to the environment, while Ethical Standards 6.1 - 6.5 added much-needed specificity regarding our responsibilities to our natural environment.

**2020 CODE OF ETHICS AND PROFESSIONAL CONDUCT**

**Canon XXI: Support Human Rights**  
Members should support the rights and dignity of all people.

**Canon XXII: Improve Workplace Culture**  
Members should create a workplace environment that is safe, healthy, and equitable.

**Canon XXIII: Oppose Torture and Execution**  
Members should oppose the practice of torture and execution in any form, including but not limited to the use of capital punishment, and should support the abolition of the death penalty.

**Canon XXIV: Protect Natural Environment**  
Members should protect the natural environment and the health and well-being of the planet.

**Canon XXV: Minimize Exposure**  
Members should appear in professional performance and behavior.

**Canon XXVI: Support Human Rights**  
Members should support the rights and dignity of all people.

**Canon XXVII: Improve Workplace Culture**  
Members should create a workplace environment that is safe, healthy, and equitable.

**Canon XXVIII: Oppose Torture and Execution**  
Members should oppose the practice of torture and execution in any form, including but not limited to the use of capital punishment, and should support the abolition of the death penalty.

**Canon XXIX: Protect Natural Environment**  
Members should protect the natural environment and the health and well-being of the planet.

**Canon XXX: Minimize Exposure**  
Members should appear in professional performance and behavior.

**2020 CODE OF ETHICS AND PROFESSIONAL CONDUCT**

**Canon XXXI: Support Human Rights**  
Members should support the rights and dignity of all people.

**Canon XXXII: Improve Workplace Culture**  
Members should create a workplace environment that is safe, healthy, and equitable.

**Canon XXXIII: Oppose Torture and Execution**  
Members should oppose the practice of torture and execution in any form, including but not limited to the use of capital punishment, and should support the abolition of the death penalty.

**Canon XXXIV: Protect Natural Environment**  
Members should protect the natural environment and the health and well-being of the planet.

**Canon XXXV: Minimize Exposure**  
Members should appear in professional performance and behavior.

**Canon XXXVI: Support Human Rights**  
Members should support the rights and dignity of all people.

**Canon XXXVII: Improve Workplace Culture**  
Members should create a workplace environment that is safe, healthy, and equitable.

**Canon XXXVIII: Oppose Torture and Execution**  
Members should oppose the practice of torture and execution in any form, including but not limited to the use of capital punishment, and should support the abolition of the death penalty.

**Canon XXXIX: Protect Natural Environment**  
Members should protect the natural environment and the health and well-being of the planet.

**Canon XL: Minimize Exposure**  
Members should appear in professional performance and behavior.



## 5. BSA Ethics Committee

**Leadership Roles:** Chair, 2012; Committee Member, 2010 - 2012

**Challenge:** Increase the relevance of ethics to the professional community through outreach to membership

**Results:**

- Instituted quarterly meeting schedule
- Organized National panel for Committee's first presentation at the Architecture Boston Expo (ABX), "Is Ethical Practice Good Practice?"
- Taught Ethics-focused professional practice seminar at Boston Architectural College
- Organized a professional ethics session for the Young Professionals Network
- Partnered with the AIA Denver Profession Fairness Task Force in creation and distribution of questionnaire to clarify regulations for providing proper credit.
- Wrote ethics articles in *ArchitectureBoston* - a journal with circulation throughout New England:
  - "Failure is an option: The value of admitting error" Sep 2018
  - "Toward an Ideal" Mar 2017
- Advised the BSA's Executive Director on the AIA's National Ethics Council procedures regarding two potential complaints
- Advised the BSA's Honors and Awards Committee on who could make nominations so as to avoid a potential conflict of interest

**Declaration of Responsibility:**

I have personal knowledge of the nominee's responsibility for the project shown above. That responsibility included: Project under the direction of the nominee as Ethics Committee Member and Chair.

Eric White, Hon. AIA, Executive Director, Boston Society for Architecture

### "Is Ethical Practice Good Practice?" BSA Ethics Committee ABX 2012 Session B63

**Justin Crane AIA**, Moderator  
BSA Ethics Committee, Architect at Cambridge Seven Associates

**Carl Sapers Esquire, Honorary AIA**  
Harvard Graduate School of Design Professor Emeritus

**Brad Walker AIA**  
National Ethics Council, Principal at Ruhl Walker Architects

**Elise Woodward AIA**  
BSA Ethics Committee, Principal at Shepley Bulfinch

**Jim Collins Jr. FAIA**  
BSA Ethics Committee, President at Payette Associates

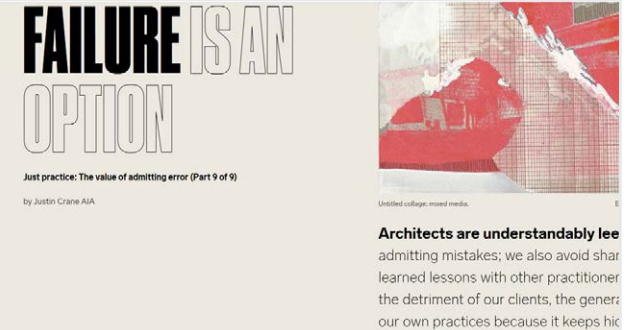

January, 2012

Fellow Architects:

The Boston Society of Architects Ethics Committee and the AIA Denver Profession Fairness Task Force would like a few minutes of your time for an important project.

In recent years nearly a third of complaints to the American Institute of Architects' National Ethics Council (NEC) have related to disputes over attribution of credit for work. These disputes arise between employer and departing employees and partners, and among architects, joint venturers and various consultants. It seems increasingly clear that the profession lacks a coherent sense of what is acceptable and ethical conduct around these issues. As part of an effort to implement a "best practices" Guideline for the Attribution of Credit, we would like your input in completing this brief survey of firm policies regarding attribution of credit issues.

Your firm's responses will remain confidential, and any presentation of findings will ensure the anonymity of your answers. This survey will require approximately 6 minutes to complete.

If you have questions about this effort or would like to participate beyond the completion of this survey, please feel free to contact us.

Sincerely,

Justin Crane, AIA, Boston Society of Architects Ethics Committee  
[jcrane@c7a.com](mailto:jcrane@c7a.com)

Tania S. Salgado, AIA, AIA Denver Profession Fairness Task Force  
[Tania.Salgado@RNLDESIGN.com](mailto:Tania.Salgado@RNLDESIGN.com)

## 6. The Foundry Building

**Leadership Role:** Project Manager, 2018-2022

**Challenge:** Design for the City of Cambridge a unique building type: a publicly-owned building run by a new non-profit with the mission of building a self-sustaining center for creativity and collaboration for local residents, including makers and artists of all backgrounds.

**Results:** Justin Crane managed CambridgeSeven's transformation of the retired industrial building in East Cambridge into a modern community destination.

- A robust series of **stakeholder meetings**, presentations, and interactive events that sourced feedback from neighbors; focus groups of local educators, maker-space users, and artists; and City departments
- An **innovative, varied, and complicated programming mix**; a memorable, high-performance space supporting community programs for the visual and performing arts, entrepreneurship, technology, workforce education, and community meetings.
- An **all-electric, net-zero-ready, and LEED Gold** building, with consideration for potential flooding in 2070 by eliminating the basement level and raising all critical mechanical equipment to the roof level
- A prime example of effective building **reuse to benefit local community groups**



Participatory community feedback art installation



*“As we work towards building a more inclusive Kendall Square, the Foundry will set the stage for breaking down those barriers. In the Foundry, we have a place for the arts, a shared space for innovation and a vision to connect all members of the Cambridge community.”*

*- Timothy Toomey, City Councilor, Retired*



101 Rogers Street, Bent Street elevation, 1935



## 6. The Foundry Building

**Declaration of Responsibility:**

I have personal knowledge of the nominee's responsibility for the project listed above. That responsibility included: *Project under the direction of the nominee as Project Manager*

Peter Kuttner, FAIA, Emeritus Principal, CambridgeSeven



Community Hall



Justin leading public meeting for the Foundry



Digital fabrication workshop

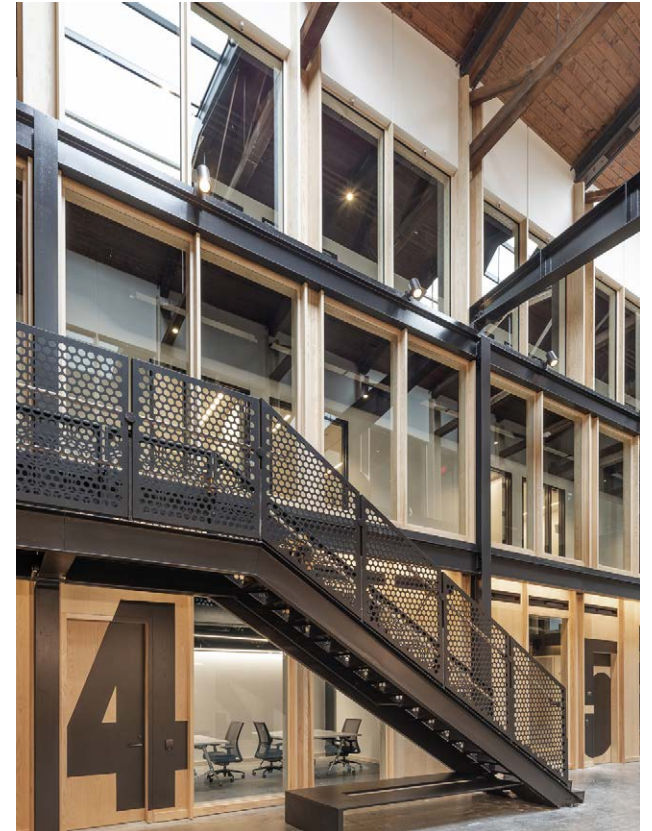

Multipurpose room entrance with supergraphics

## 7. Nettie M. Stevens Science and Innovation Center, Westfield State University

**Leadership Role:** Project Architect, 2014-2017

**Challenge:** Westfield State University had not built a new academic building on its main campus in 40 years. Teaching space was limited and labs were badly outdated, hampering the school's ability to deliver valuable STEM programming and retain faculty in competition with better-funded private institutions.

**Results:** Developed a two-phase plan for renovations and upgrades to the existing buildings, **connected** to a new, energy-efficient science and technology center, providing state-of-the-art facilities to an affordable state university:

- Renovations to Wilson Hall, home of WSU's science labs and main lecture halls
- A new 59,000 GSF addition to Wilson Hall that houses teaching and research laboratories for Biology, Chemistry and Environmental Science along with state-of-the-art teaching space for the WSU's Nursing program.
- The environmentally sustainable, high-performance Center received LEED Silver certification and includes the Innovation Center: a flexible multi-purpose space that supports TEAL (Technology-Enhanced Active Learning) directed teaching, provides space for the Economics and Management Department's trading room, and highly sought break-out space for project-based, student-led work.



Glass-enclosed stair provides new landmark on Western Ave.



Connecting stair between new Stevens Center and renovated Wilson Hall



Stevens Center provides new chemistry, biology, and environmental studies labs

---

*2018 Best in Class Winner  
Brick in Architecture Awards*

---

## 7. Nettie M. Stevens Science and Innovation Center, Westfield State University

**Declaration of Responsibility:**

I have personal knowledge of the nominee's responsibility for the project listed above. That included being largely responsible for design as *Project Architect*

Peter Kuttner, FAIA, Emeritus Principal, CambridgeSeven



Nursing Simulation Center



Corridor widens to provide informal break-out space



East brick façade is a new variation on the campus' masonry buildings

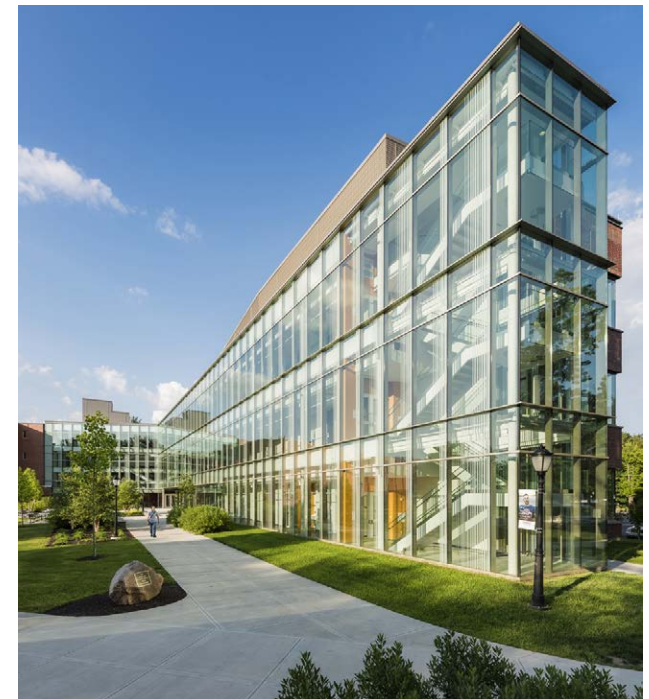

West glass façade encloses new academic quad

## 8. New England Aquarium Master Plan and Giant Ocean Tank

**Leadership Role:** Project Architect, 2011-2013

**Challenge:** Fifty years after opening, the New England Aquarium required upgrades to address sea level rise from a changing climate, update exhibits that were not universally accessible, and repair concrete and glass in the aquarium's pioneering, but outdated, 200,000-gallon Giant Ocean Tank.

### Results:

- Created the Aquarium's open space master plan, consolidating input from stakeholder charrettes, visitor surveys, and research into the institution's existing facilities. The Master Plan addressed expansion of the Aquarium with a planned new mammal pavilion and outdoor experience on the downtown waterfront site.
- Led the renovation of the original building and its Giant Ocean Tank to include refinement of the tank viewing and visitor route. New features include:
  - Larger, state-of-the-art windows - lowering the sill to increase view access by visitors at all eye levels
  - A new bridge and elevator stop making the top universally accessible
  - Transformation of back-of-house lab space into a new exhibit advocating for ocean stewardship
  - New lighting design to highlight the new habitat and marine life
  - Introduction of new presentation platforms accommodate demonstrations and more visitor engagement
  - New graphics at the perimeter of the tank as well as a new domed lighting effect to intensify the immersion



Justin and Peter Kuttner FAIA accepting the BSA Accessible Design Award

### IMAX Reuse

3.3c GEO-CLIMATE LEARNING "LAB" AND CLIMATE CHANGE EXHIBIT

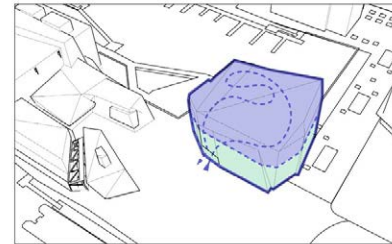

3.3d GEO-CLIMATE LEARNING "LAB" WITH EDUCATION CENTER

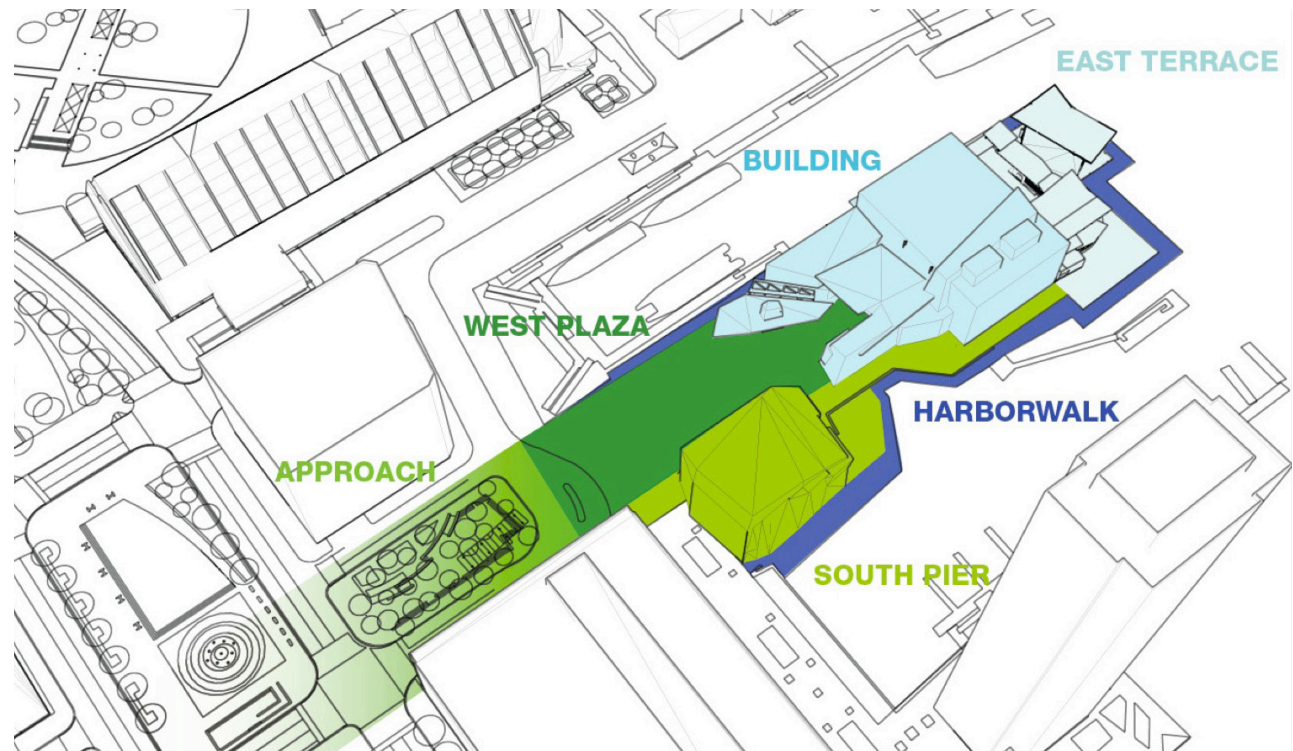
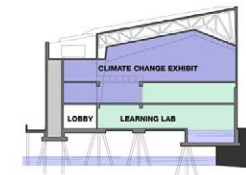
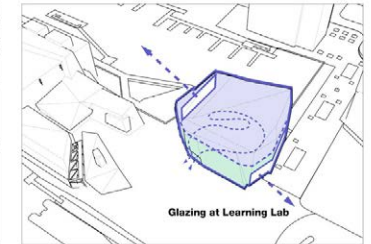

2012 Master Plan for the New England Aquarium studied renovation and reuse of open space and existing buildings on Central Wharf

## 8. New England Aquarium Master Plan and Giant Ocean Tank

**Declaration of Responsibility:**

I have personal knowledge of the nominee's responsibility for the project listed above. That included being largely responsible for design as *Project Architect*

Peter Kuttner, FAIA, Emeritus Principal, CambridgeSeven

2016 Accessible Design Award  
Boston Society for Architecture



Giant Ocean Tank renovation made exhibits newly accessible and included larger view panels, new habitats, graphics, lighting, and life safety systems throughout the main atrium

